



PJM Connect Roadmap

As of August 18, 2020

- Updated Impact Details and Roadmap slides to reflect that the Single Sign Integration (SSO) is implemented as of July 17
- Removed access issue slide; this has been resolved with the PJM Connect/SSO integration

Product - Action Required	Dates	Who May Be Affected
N/A	N/A	N/A





Legend

- Start Date
- ◆ End Date



Previously, PJM Connect prompted users for their accounts via the web browser and use the following format: DMZ\username

After integration, users are directed to Single Sign-On and DMZ\ is no longer required

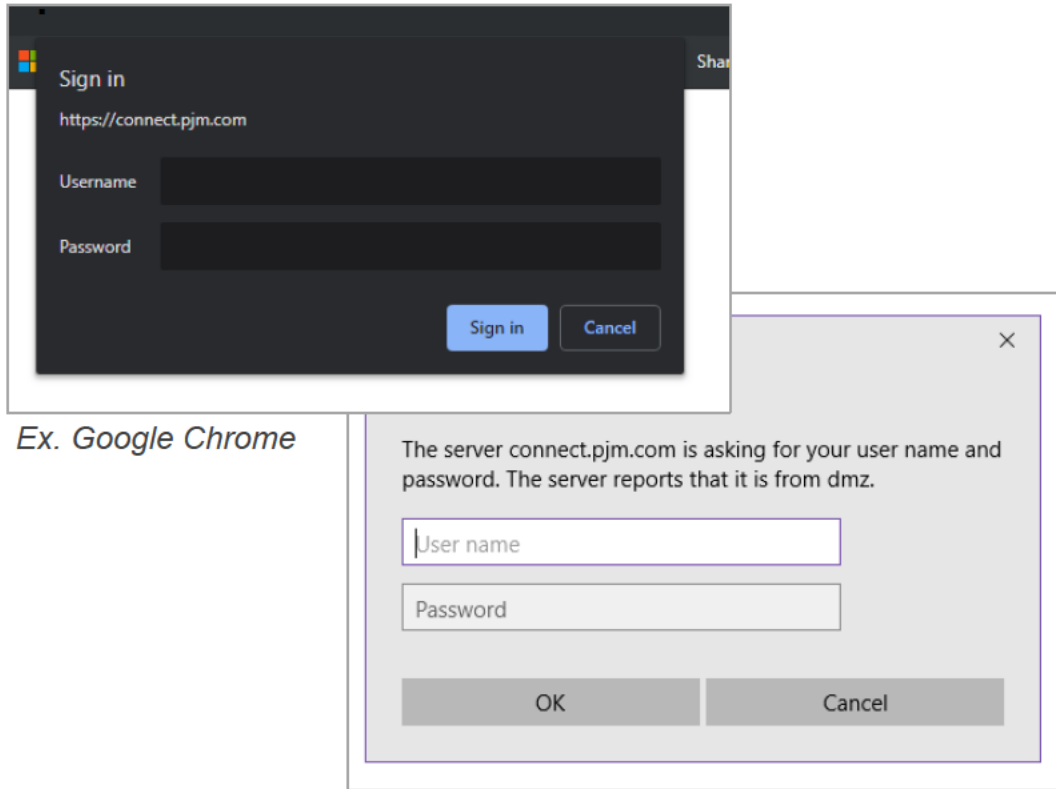

Ex. Google Chrome

Ex. Windows Internet Explorer



- During PJM's network issues, PJM Connect remained available
- As a workaround for Secure Share during the outage, PJM Connect created private, individual libraries for PJM personnel to share with external stakeholders.
 - This option is a core feature of SharePoint and is available for any site in the future

Report issues or submit questions to:

- PJM's [Member Relations](#) or call (610) 666-8980
- SharePointConnectAdmins@pjm.com
- Your site's PJM employee owner

Tech Change Forum

- [Educational recording](#)



Product Details

PJM Connect, PJM's external SharePoint site, allows PJM personnel and external stakeholders to collaborate and share data.

Key Product Features

- Enables users to create robust, individualized sites to organize their projects, initiatives and tasks specific to their needs
- Using SharePoint apps, users can organize document submissions, data sets and calendars all in one site